

Legend

Existing Minor Contour Line

Existing Major Contour Line

Proposed Minor Contour Line

Proposed Major Contour Line

Control Point

Limits of Construction

Edge of Lake

Edge of Trees

Riprap

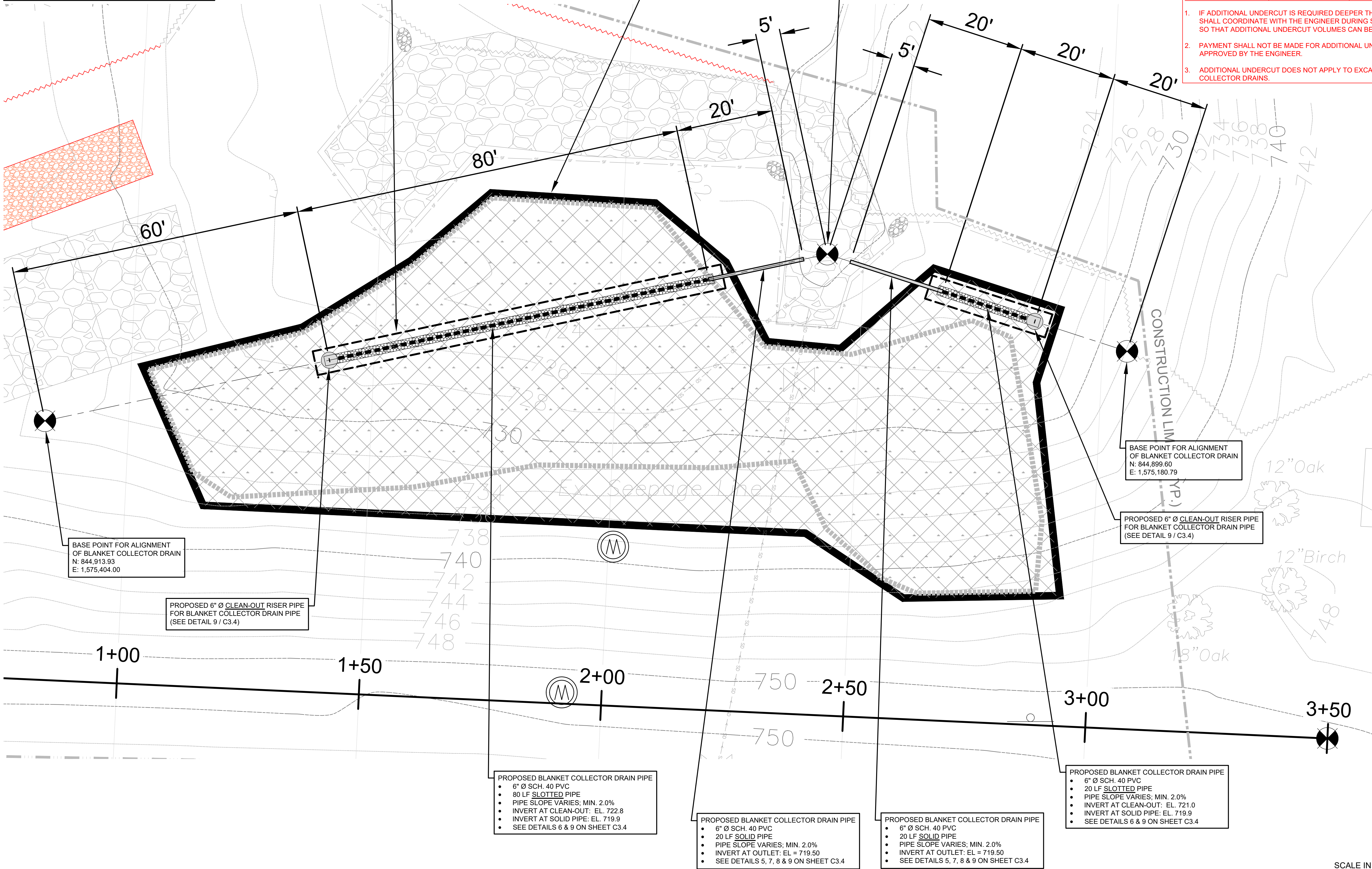

PROPOSED BLANKET COLLECTOR DRAIN PIPE (TYP)

NOTES:

- THE EXACT LOCATION AND ALIGNMENT OF THE BLANKET COLLECTOR DRAIN TRENCH / PIPE CAN BE SLIGHTLY ADJUSTED TO ACCOMMODATE FIELD CONDITIONS ENCOUNTERED TO PROVIDE POSITIVE DRAINAGE OF THE RESPECTIVE PROPOSED SAND BLANKET AREA.
- ANY MODIFICATIONS SHALL BE COORDINATED WITH AND APPROVED BY THE ENGINEER PRIOR TO EXCAVATING FOR THE BLANKET COLLECTOR DRAIN TRENCH.

PROPOSED EXTENTS OF C-33 CLEAN SAND BLANKET DRAIN (APPROX.)

NOTES:

- THE EXTENTS OF THE PROPOSED SAND BLANKET SHOWN ARE APPROXIMATE (9,675 SF).
- IF THE SEEPAGE / WET AREA HAS EXPANDED AT THE TIME OF CONSTRUCTION, THEN THE PROPOSED SAND BLANKET SHALL BE EXPANDED TO ENCOMPASS THE RESPECTIVE SEEPAGE / WET AREAS. DURING CONSTRUCTION, THE ENGINEER SHALL DETERMINE THE FINAL EXTENTS OF THE PROPOSED SAND BLANKET.

SAND BLANKET DRAIN NOTES:

- A MINIMUM OF 12 INCHES OF C-33 SAND SHALL BE PLACED ON THE APPROVED SUBGRADE TO CONSTRUCT THE BLANKET DRAIN.
- THE BLANKET DRAIN (AND BLANKET COLLECTOR DRAIN) SHALL BE PROTECTED FROM CONTAMINATION DURING THE CONSTRUCTION PROCESS; ANY CONTAMINATED PORTIONS SHALL BE REMOVED AND REPLACED AT THE CONTRACTOR'S EXPENSE.
- THE FOUNDATION AREA FOR THE TOE OF DAM EXTENSION AND BLANKET DRAIN SHALL BE EVALUATED BY THE GEOTECHNICAL ENGINEER TO DETERMINE THE DEPTH AND EXTENT OF ANY UNDERCUT NECESSARY (A DEPTH OF 2 FEET HAS BEEN ASSUMED FOR THESE REPAIR PLANS).
- UNDERCUT AND BACKFILLING SHALL BE PERFORMED IN SMALL SECTIONS WHICH ALLOW FOR THE OPERATION TO BE COMPLETED DAILY.
- NO UNDERCUT EXCAVATIONS SHALL BE LEFT OPEN OVERNIGHT.
- PRIOR TO UNDERCUT OPERATIONS, THE CONTRACTOR SHALL MAINTAIN ON-SITE AT LEAST ONE ROLL OF NON-WOVEN GEOTEXTILE FILTER FABRIC EQUAL TO MIRAFI 160N AND 100 CUBIC YARDS OF C-33 SAND IN THE EVENT THAT UNDERCUT OPERATIONS EXPOSE PRESSURIZED SEEPAGE WHICH NEEDS TO BE COUNTERED WITH A WEIGHTED FILTER AS AN EMERGENCY MEASURE.

ADDITIONAL UNDERCUT (DEEPER THAN 3.0 FEET) NOTES FOR SAND BLANKET DRAIN:

- IF ADDITIONAL UNDERCUT IS REQUIRED DEEPER THAN 3.0 FEET, THE CONTRACTOR SHALL COORDINATE WITH THE ENGINEER DURING SUCH UNDERCUT OPERATIONS SO THAT ADDITIONAL UNDERCUT VOLUMES CAN BE OBSERVED AND QUANTIFIED.
- PAYMENT SHALL NOT BE MADE FOR ADDITIONAL UNDERCUT NOT OBSERVED OR APPROVED BY THE ENGINEER.
- ADDITIONAL UNDERCUT DOES NOT APPLY TO EXCAVATION REQUIRED FOR BLANKET COLLECTOR DRAINS.

STATE DAM ID: FORSY-033 (LOW HAZARD)

LAKE MARBLEHEAD DAM REPAIRS  
TOWN OF LEWISVILLE  
LEWISVILLE, NC - FORSYTH COUNTY

PROPOSED SEEPAGE COLLECTION PLAN

DATE: DECEMBER 2024  
DESIGNED: JTG  
DRAWN: DNH  
JOB NO: 23-150-23-1  
SHEET: C3.1  
OF: 12

NO PART OF THIS DOCUMENT MAY BE REPRODUCED OR DISTRIBUTED IN ANY FORM OR BY ANY MEANS WITHOUT THE WRITTEN PERMISSION OF GRIMES ENGINEERING, P.C. THIS DOCUMENT IS TO BE USED ONLY FOR THE PROJECT SPECIFIED BY GRIMES ENGINEERING, P.C.

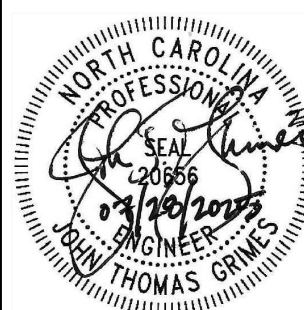

LICENSE NO. C-2909

FINAL DRAWING - ISSUED FOR CONSTRUCTION

MARK	REVISIONS	BY	DATE
*R-2*	BID PHASE ADDENDUM NO. 1 REVISIONS	JTG	07/28/24
*R-1*	ISSUED FOR CONSTRUCTION	JTG	07/15/25



SCALE IN FEET (1" = 10')

0 5 10 20 30 40